



Gateway of Pacific V

475 Eccles Ave
South San Francisco, CA

LOCATION

Anchoring the entrance to South San Francisco at its most prominent intersection is Gateway of Pacific, a new landmark being developed over several phases to provide ± 2.2 m square feet of state-of-the art life science space in an inspiring urban park setting.



Gateway
of Pacific III

Gateway
of Pacific II

Gateway
of Pacific I

Gateway
of Pacific IV

Gateway
of Pacific V

Square Footage

RENTABLE SQUARE FOOTAGE

180/200 ±205,000
Leased

GOP I ±509,000
Available ±29,000

GOP II ±441,000
Leased

GOP III ±350,000
Available 2H 2021

GOP IV ± 265,000
Available

GOP V ±306,000
Available



Campus Features

OVERVIEW

NUMBER OF BUILDINGS

10

RENTABLE SQUARE FEET

±2,200,000 fully-integrated life science campus

LOCATION

Located at the main intersection of South San Francisco's life science cluster

Convenient access to Caltrain, BART, Bay Ferry, SFO Airport, US-101, I-380 & I-280

Prominent identity from US-101 freeway

AMENITIES

Underground parking

TRAVERSE ±50,000 SF free-standing amenity center

FORUM conference center

GATEWAY CENTRAL PARK is a zen-like environment for connection and collaboration outside of the office or laboratory. The Park is uninterrupted by vehicles and offers a variety of park-like experiences on ±5.5 acres—from highly social places for interaction to areas for quiet contemplation



TRAVERSE

**RENEW. RECHARGE. REVITALIZE
AT TRAVERSE**

At the heart of the campus, TRAVERSE—a state-of-the-art amenity center—offers a personalized array of culinary, fitness and community experiences that empower moments of connection and collaboration.

SQUARE FOOTAGE
±50,000

AMENITIES

Bar and Restaurant

Food Hall

Meeting Spaces

Spa & Health Club

CERTIFICATIONS

LEED® Platinum and Fitwel 2 rating



TRAVERSE

FLOOR PLAN

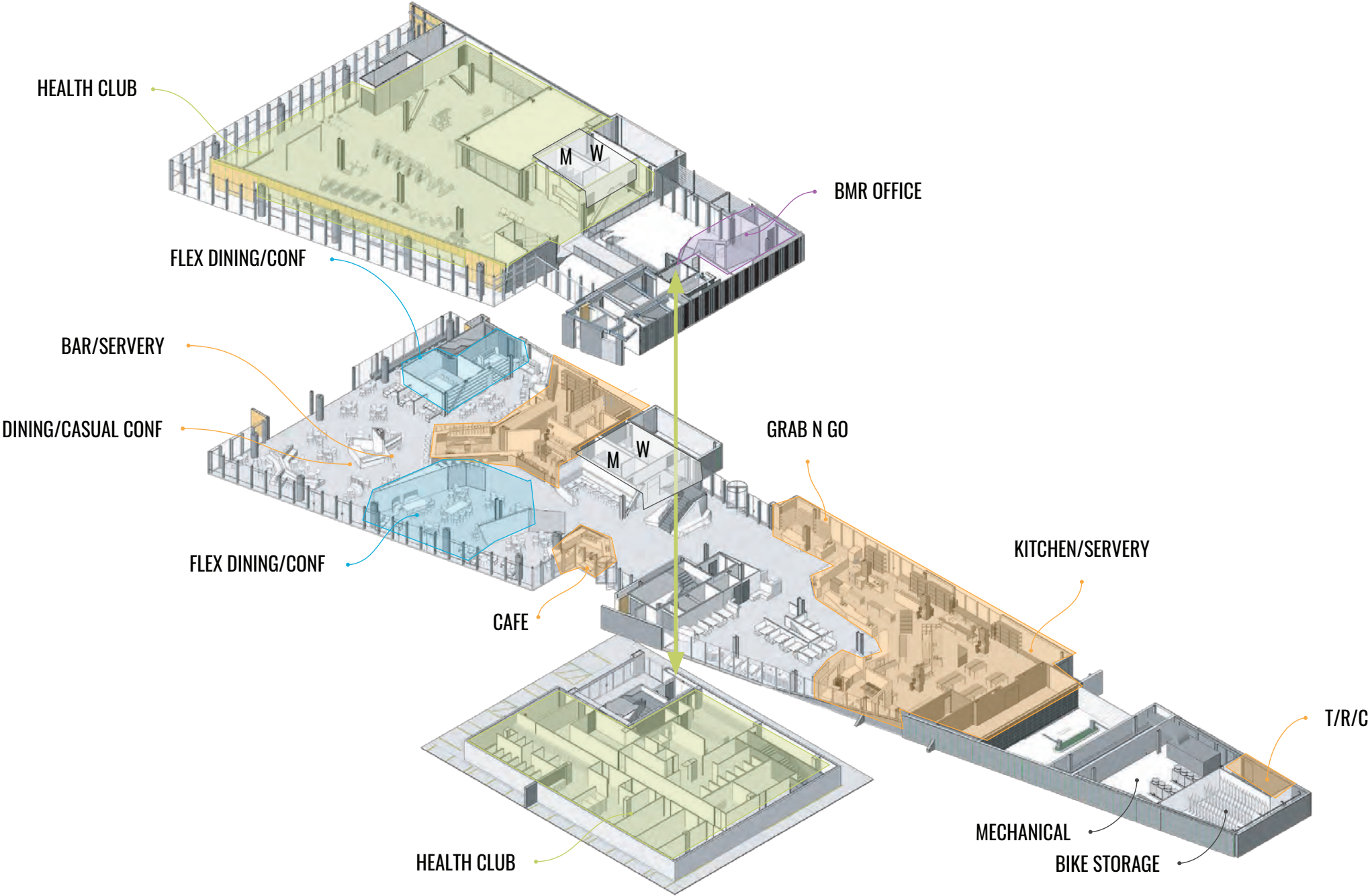



TR~~A~~VERSE

RENDERINGS





Gateway of Pacific V

OVERVIEW

NUMBER OF BUILDINGS
2

TOTAL RENTABLE SQUARE FOOTAGE
±306,000



Gateway of Pacific V

EXTERIOR VIEW RENDERING



Gateway of Pacific V

EXTERIOR VIEW RENDERING



Gateway of Pacific V

EXTERIOR VIEW RENDERING

International Footprint Focused on Highest Quality Core Life Science Markets



13.5 MILLION SF
of rentable space

2.5 MILLION SF
of active development pipeline

100% PRESENCE
in core life science markets

About BioMed Realty

BioMed Realty, a Blackstone portfolio company, is a leading provider of real estate solutions to the life science and technology industries.

We support a deep and varied roster of life science and technology companies.



FULL-SERVICE OPERATING PLATFORM
customizable to help tenants maximize operating efficiencies

DEVELOPMENT CAPABILITIES
with state-of-the-art technological and design expertise

STRATEGIC PROVIDER
of real estate capital with substantial funds available for investment

Scott Altick
Vice President,
San Francisco Market Lead
c 510 505 6044
scott.altick@biomedrealty.com



biomedrealty.com